

Table: Venue and equipment rental rate for NTU classroom buildings (before tax)

Item			Half day	Full day	Evening	Notes	
Period of use (including venue preparation time)			0800-1200 1300-1700	0800-1700	1800-2200	<ol style="list-style-type: none"> Cleaning fee: Including fees for water, electricity, general waste processing, desks and chairs, and electric fans, but excluding air conditioning and audiovisual teaching equipment. For rentals of 5 classrooms or more in the same session, a 20% discount is offered on air conditioning and audiovisual teaching equipment; for rentals of ten classrooms or more in the same session, a 30% discount shall apply. The air conditioning temperature shall be set in accordance with NTU regulations. Usage exceeding the rental period is limited to one hour, which shall be charged based on the average hourly rate of that session. A period less than one hour shall be billed as one hour. For renters requiring additional preparation time at the venue, a 50% discount off the amount stipulated in the rental rate shall apply for the preparation time. The venues do not provide Wi-Fi Internet services; each venue only offers one computer with Internet access for use by renters of audiovisual teaching equipment. Off-campus units shall be charged an additional tax. 	
Cleaning fee	Classrooms in the Boya Lecture Building (2 nd to 4 th floor), Freshmen Classroom Building, Multi-Purpose Classroom Building, Core Subjects Classroom Building, and Common Subjects Classroom Building	1-10 venues	Under 50 persons	NT\$2,000 /room	NT\$3,800 /room		NT\$3,800 /room
			51-100 persons	NT\$2,200 /room	NT\$4,200 /room		NT\$4,200 /room
			101-200 persons	NT\$2,400 /room	NT\$4,600 /room		NT\$4,600 /room
			Over 201 persons	NT\$2,600 /room	NT\$5,000 /room		NT\$5,000 /room
		11 venues or more	Under 50 persons	20% off			
			51-100 persons				
			101-200 persons				
			Over 201 persons				
	Room 101, Boya Lecture Building (holds 400 persons)			NT\$4,000 /room	NT\$8,000 /room		NT\$8,000 /room
	Room 102, Boya Lecture Building (holds 400 persons)			NT\$3,000 /room	NT\$6,000 /room	NT\$6,000 /room	
Room 103, Boya Lecture Building (holds 278 persons)			NT\$3,000 /room	NT\$6,000 /room	NT\$6,000 /room		
NTU Lecture Hall, Multi-Purpose Classroom Building (holds 568 persons)			NT\$40,000 /room	NT\$80,000 /room	NT\$80,000 /room		
Air conditioning fee			NT\$1,500 /room	NT\$3,000 /room	NT\$2,000 /room		

Rental fees for audiovisual teaching equipment	Electronic equipment (including computers, projectors, screens, and other teaching equipment) in classroom buildings	5,500 lumens	Venue with 1 projector	NT\$2,000 /set	NT\$3,000 /set	NT\$2,000 /set	7. Service fees: NT\$1,200 per daytime session; NT\$1,500 per evening session. (an additional NT\$300 per hour will be charged for early or overtime use of a venue during a daytime session or NT\$375 per hour in the evening; an additional period of use less than one hour will be calculated as one hour.) An additional NT\$500 per session shall be charged for conference equipment rentals. Venue rentals of eleven classrooms or more may incur double fees.
			Venue with 2 projectors	NT\$2,200 /set	NT\$3,200 /set	NT\$2,200 /set	
			Venue with 3 projectors	NT\$2,400 /set	NT\$3,400 /set	NT\$2,400 /set	
			Venue with 4 projectors	NT\$2,600 /set	NT\$3,600 /set	NT\$2,600 /set	
	Laptops			NT\$2,000 /each	NT\$3,000 /each	NT\$2,000 /each	
	Laser pointers			NT\$100 /each	NT\$150 /each	NT\$100 /each	
	Digital signage system (Common Subjects, Freshmen, and Core Subjects Classroom Buildings)			NT\$500 /each	NT\$750 /each	NT\$500 /each	
	Scrolling LED displays			NT\$2,000 /each	NT\$3,000 /each	NT\$2,000 /each	
	Wall-mounted screens (4-in-1), 1 st floor, Boya Lecture Building			NT\$2,000 /each	NT\$3,000 /each	NT\$2,000 /each	
	Wall-mounted screens (18-in-1), 1 st floor, Multi-Purpose Classroom Building			NT\$5,000 /each	NT\$7,500 /each	NT\$5,000 /each	

Table: Venue rental rate for the Exhibition Hall of the Boya Lecture Building (before tax)

Available area	Rate (per day)		Notes
	Off-campus unit	On-campus unit	
Exhibition wall/pillars in the central hallway on the 1 st floor	NT\$6,000	NT\$3,000	1. Open from 8:00 am–6:00 pm Monday to Friday (excluding public holidays) 2. Venue is an open space with no air-conditioning. 3. Venue rentals of 5 days or more are eligible for a 15% discount.
Bookstall area in the west hallway on the 1 st floor	NT\$3,000	NT\$2,000	

Figure: Floor plan of the Exhibition Hall on the 1st floor of the Boya Lecture Building

博雅教學館一樓藝文空間平面圖

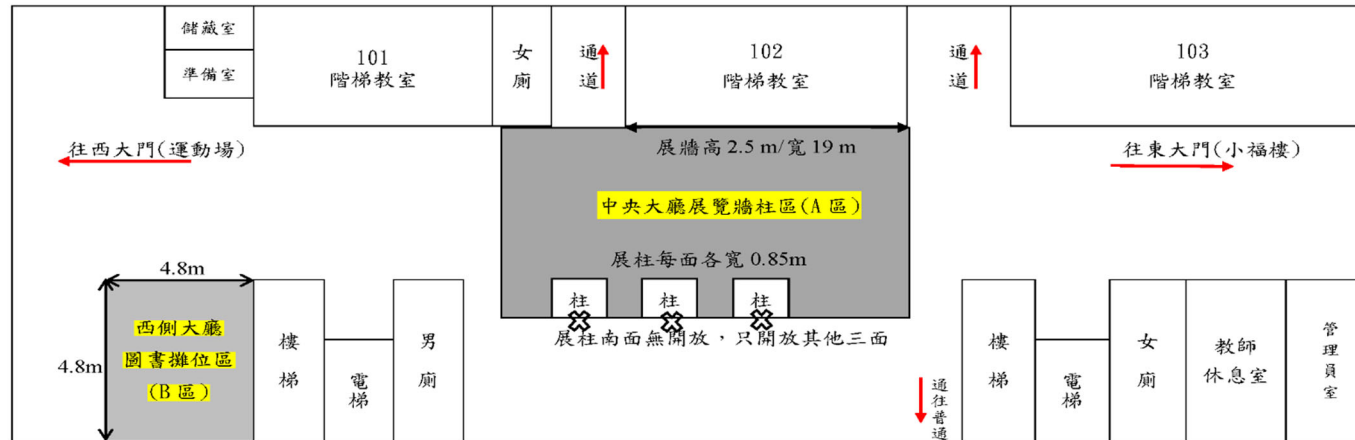

Table: The Office of Academic Affairs–Learning Commons Rental Fee Schedule (before tax)

Venue	Learning Commons (Multi-purpose Classroom Building)			1 st Fl. capacity: 103 people
				2 nd Fl. capacity: 84 people
Time of use (including venue preparation time)	Half day	Full day	Evening	<p>Notes:</p> <ol style="list-style-type: none"> Cleaning fee includes charges for water, electricity, general waste processing, desks and chairs, and electric fans, but excludes usage of air conditioning and audiovisual teaching equipment. On-campus units renting the Learning Commons shall be charged 50% of the cleaning fee. However, for events of any of the following nature, renters shall only be charged 80% of the cleaning fee: (1) Events co-organized or organized jointly with an off-campus unit (2) Events sponsored by an off-campus unit (3) Events where participants are charged The air conditioning temperature shall be set in accordance with University regulations. Usage exceeding the rental period is limited to one hour, which shall be charged based on the average hourly rate of that time period. A period less than one hour shall be billed as one hour. If the renter requires additional preparation time at the venue, it shall be charged 50% of the rate in that time period for the preparation time. The Learning Commons does not provide wireless Internet services. Off-campus units shall be charged for tax. Service fees: NT\$1,200 per day session; NT\$1,500 per evening session. (Early or overtime use of a venue shall be charged at an additional NT\$300 per hour in the day or NT\$375 per hour in the evening; an additional period of use of less than one hour shall be billed as one hour.)
	0800–1200 1300–1700	0800–1700	1800–2200	
Cleaning fee	NT\$ 2000 per venue	NT\$ 3,800 per venue	NT\$ 3,800 per venue	
Projection equipment	NT\$ 2,000 per set	NT\$ 3,000 per set	NT\$ 2,000 per set	
Air conditioning	NT\$ 1,500 per venue	NT\$ 3,000 per venue	NT\$ 2,000 per venue	

Figure: Procedural flowchart for venue rentals at NTU classroom buildings

